

IMPORTANT NOTICE – HANDLING AND PRE-INSTALL CHECKS

1. **DO NOT** lean the shower tray against the wall

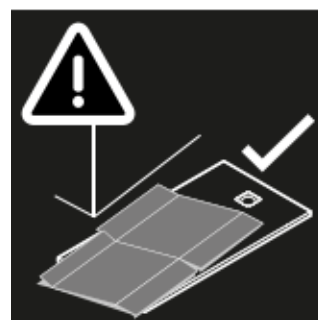
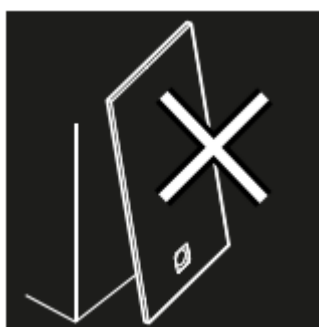

tray should be stored
surface

Shower
on a flat

2. **Do not** store on a pallet smaller than the size of the shower tray
3. **Do not** allow the shower trays to overhang the pallet. During storage, the shower tray must be supported flat over its entire surface base



NOTES TO INSTALLER

4. Check flatness of the shower tray **BEFORE** installation. Do not proceed to install a deformed tray that may have been affected by improper handling.

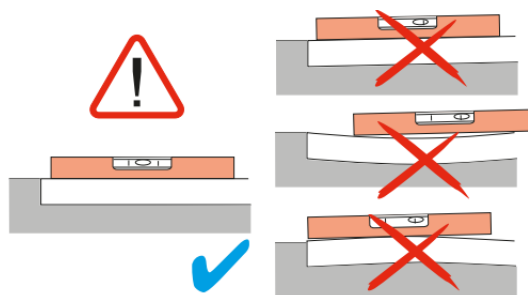
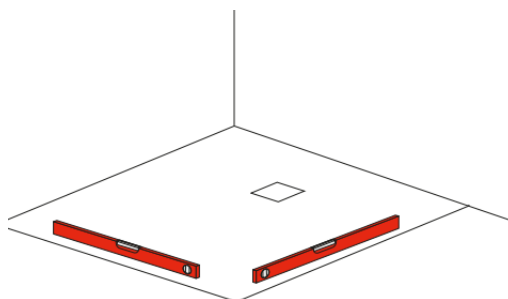

5. **BEFORE** installation, check whether water flows off the surface of the shower tray.

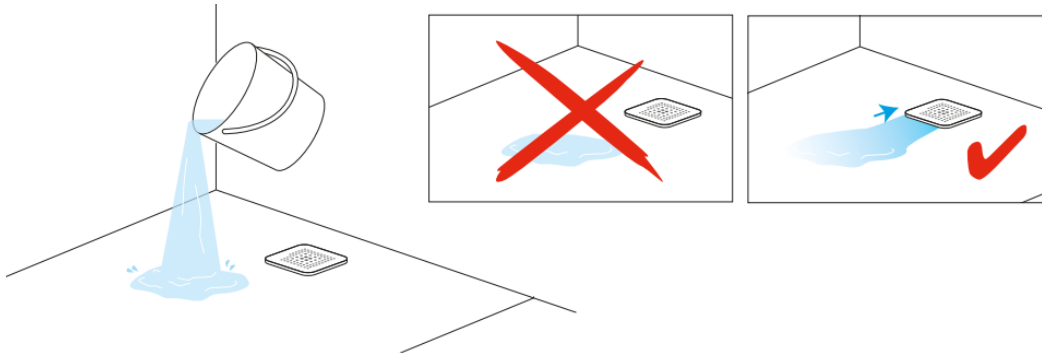

NOTES TO INSTALLER

6. Glue with an evenly distributed flexible adhesive:

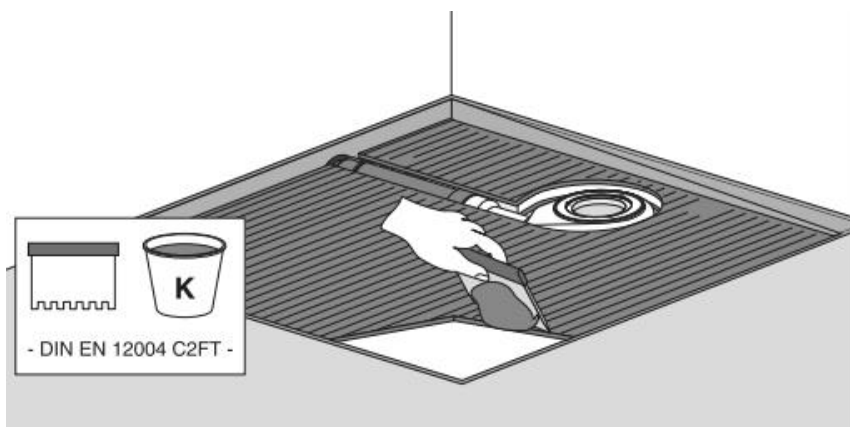

7. Observe and allow for expansion joints as per drawing below:

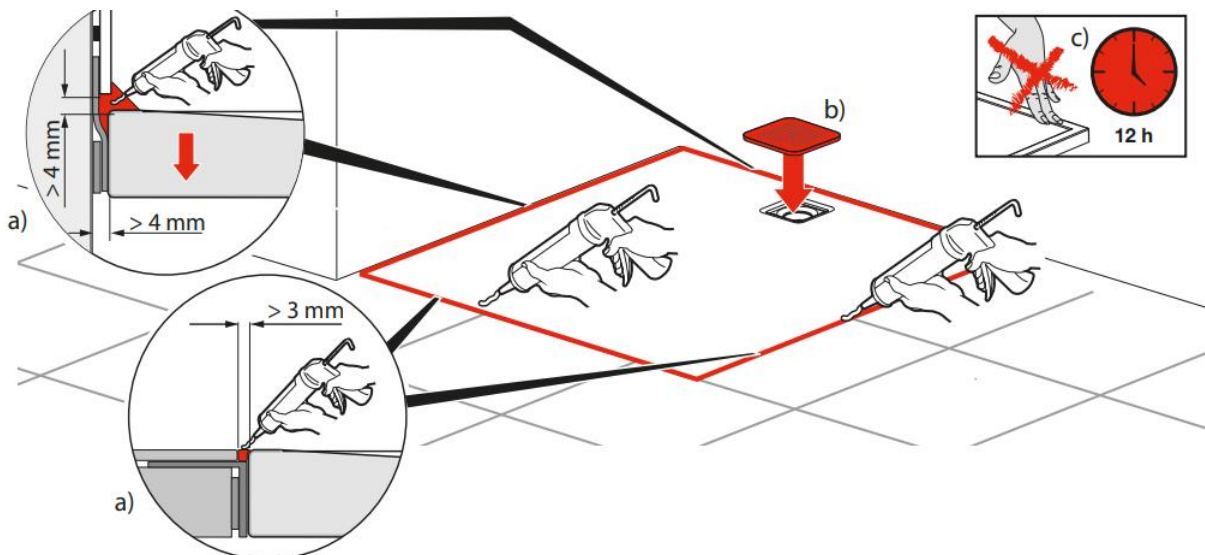

8. Ensure Shower head position is not directly over the drain and is in the first half of the shower tray.

